



VICTORIA'S LARGEST CONFERENCE HOTEL

FACILITY HIGHLIGHTS

- Air-conditioned meeting space
- On-site audio visual company
- Catering to accommodate all needs
- Complimentary business centre
- Complimentary high speed wireless Internet
- Secure underground parking

MEETING ROOMS

EAST HARBOUR BALLROOM

- Accommodates 30 to 300 people
- Adjoining Mezzanine reception or tradeshow area
- Mezzanine office
- Divisible into 2 Salons
- Private washrooms
- Wheelchair accessible

WEST HARBOUR BALLROOM

- Accommodates 40 to 350 people
- Natural light
- Private exterior entrance
- 2 versatile levels
- Private washrooms
- Wheelchair accessible

SECOND FLOOR MEETING ROOMS

- Accommodates 10 to 50 people
- 6 meeting rooms & 1 boardroom
- 4 adjoining rooms
- Natural light
- Wheelchair accessible

LOOKOUT ROOM

- Accommodates 10 to 80 people
- Penthouse level meeting room
- Natural light with views over the Inner Harbour
- Spacious upper level
- Intimate lower level
- Balcony on both levels
- 2 private washrooms

EAST HARBOUR MEZZANINE



WEST HARBOUR BALLROOM



LOOKOUT ROOM



Visit www.harbourtowers.com to learn more about our services and facilities.

Room Capacities										
	Total Sq. Ft.	Room Size	Classroom	Theatre	Banquets 10	1/2 Rounds	Reception	Boardroom	U-Shape	H-Square
East Harbour Ballroom	2760	92' x 30'	140	290	280	170	300	-	-	-
Mezzanine	1428	51' x 28'	-	-	-	-	75	-	-	-
Salon A	1260	42' x 30'	60	100	100	60	130	40	40	45
Salon B	1500	50' x 30'	80	150	150	90	170	40	40	44
West Harbour Ballroom	4215	-	-	-	320	192	350	-	-	-
Upper Level	2430	45' x 54'	100	200	200	120	250	40	-	-
Lower Level	1785	35' x 51'	60	170	120	72	150	40	35	-
Lookout Room 1207	850	50' x 17'	46	80	50	32	80	40	35	30
Pacific Room 1214	442	26' x 17'	15	35	18	-	35	22	20	-
Executive Room 201	288	24' x 12'	-	-	-	-	-	20	-	-
Victoria Room 203	576	24' x 24'	30	50	40	24	40	26	24	26
Saanich Room 205	576	24' x 24'	30	50	40	24	40	26	24	26
Esquimalt Room 207	456	24' x 19'	24	35	30	18	30	22	20	22
Oak Bay Room 209	456	24' x 19'	24	35	30	18	30	22	20	22
James Bay Room 211	384	24' x 16'	20	35	30	18	30	22	20	22
Laureate Room 213	360	24' x 15'	12	25	20	12	25	18	16	15

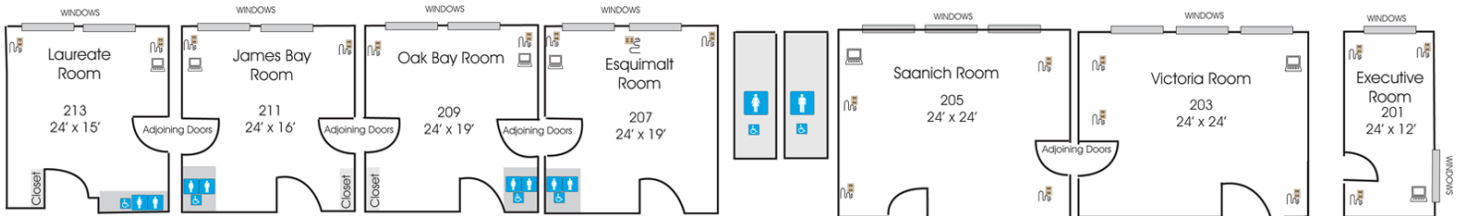

West Harbour Ballroom

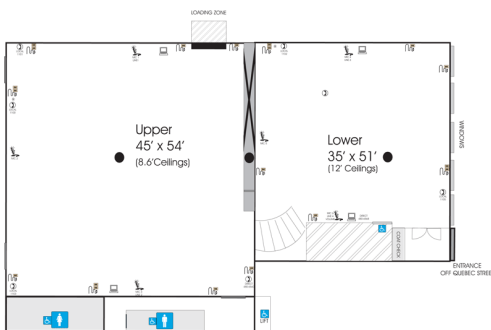

The Lookout Room

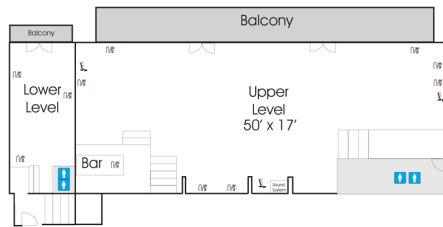

East Harbour Ballroom

